

LEGENDA / LEGEND



Bloccare con frenafilietti: L= Leggera - M= Media - S= Forte
Lock with the threadlocker: L= Light - M= Medium - S= Strong



Lubrificare ✓ / Lubricate ✓
Non lubrificare ✗ / Do not lubricate ✗
Solo primi filetti ✓ / First threads only ✓





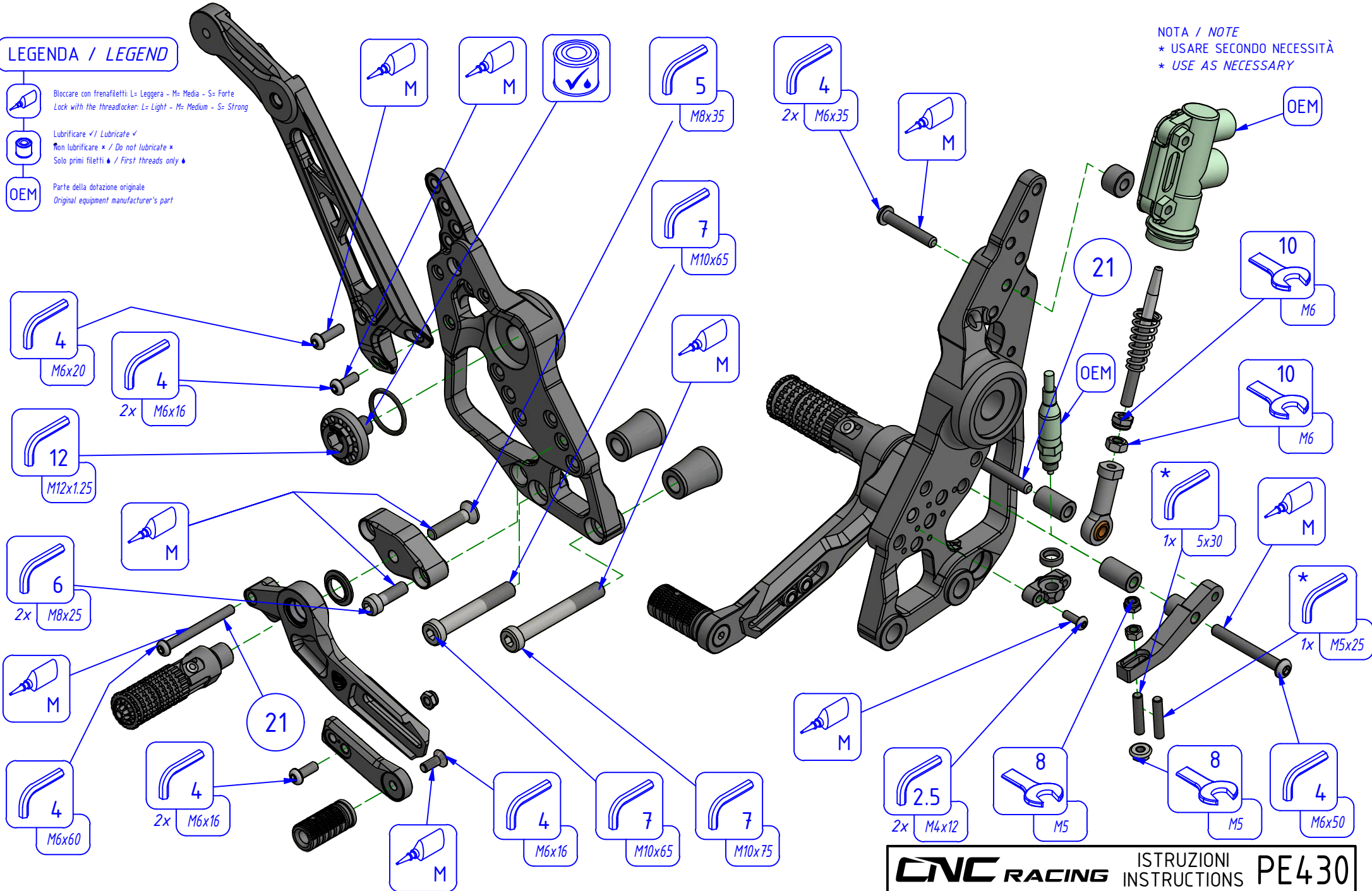

Parte della dotazione originale
Original equipment manufacturer's part



NOTA / NOTE
* USARE SECONDO NECESSITÀ
* USE AS NECESSARY

LEGENDA / LEGEND

-  Bloccare con frenafiletti: L= Leggera - M= Media - S= Forte
Lock with the threadlocker: L= Light - M= Medium - S= Strong
-  Lubrificare ✓ / Lubricate ✓
-  Non lubrificare ✗ / Do not lubricate ✗
-  Solo primi filetti ◆ / First threads only ◆
-  OEM
Parte della dotazione originale
Original equipment manufacturer's part

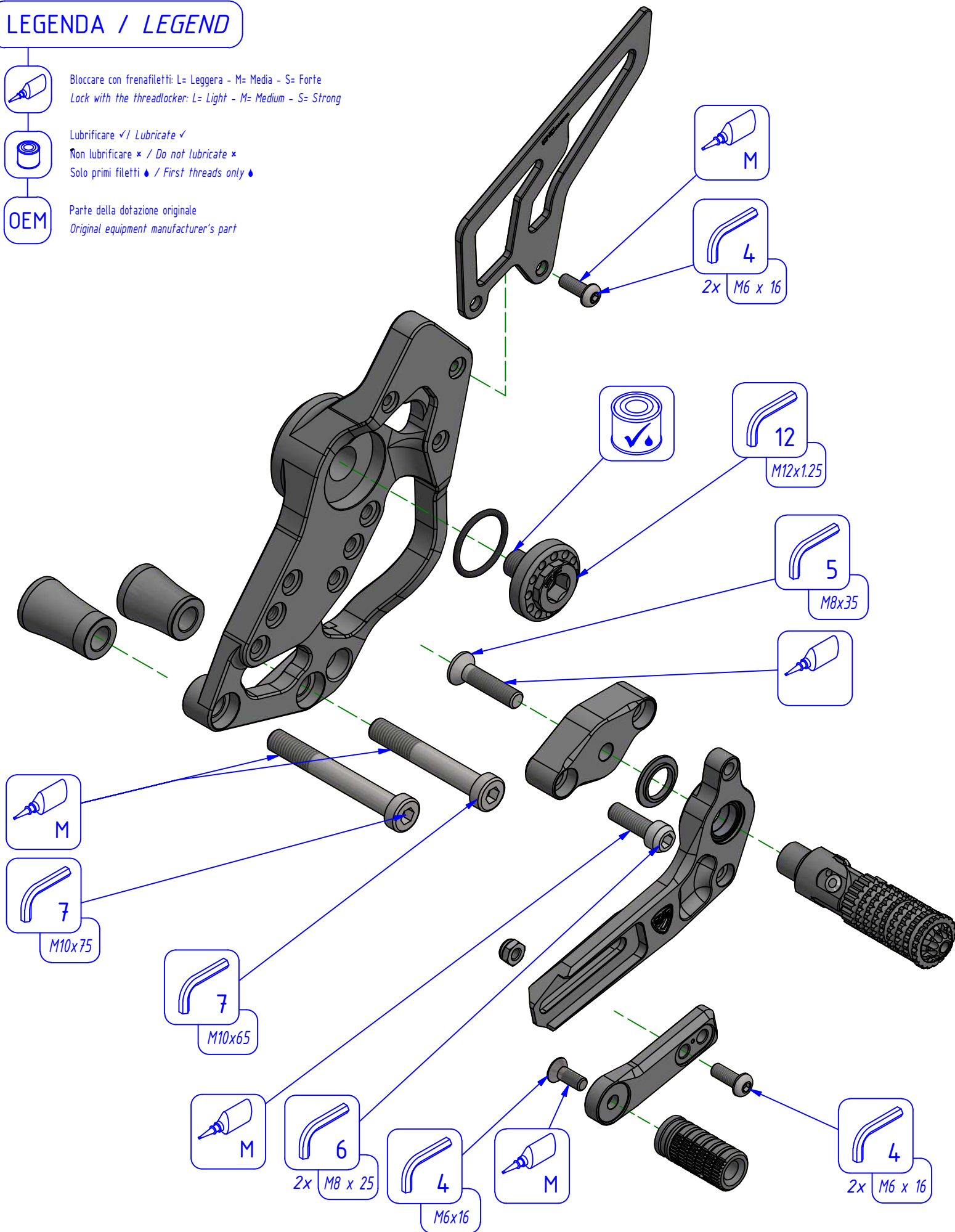

**VERSIONE CAMBIO ROVESCO
REVERSE SHIFTING SETUP**

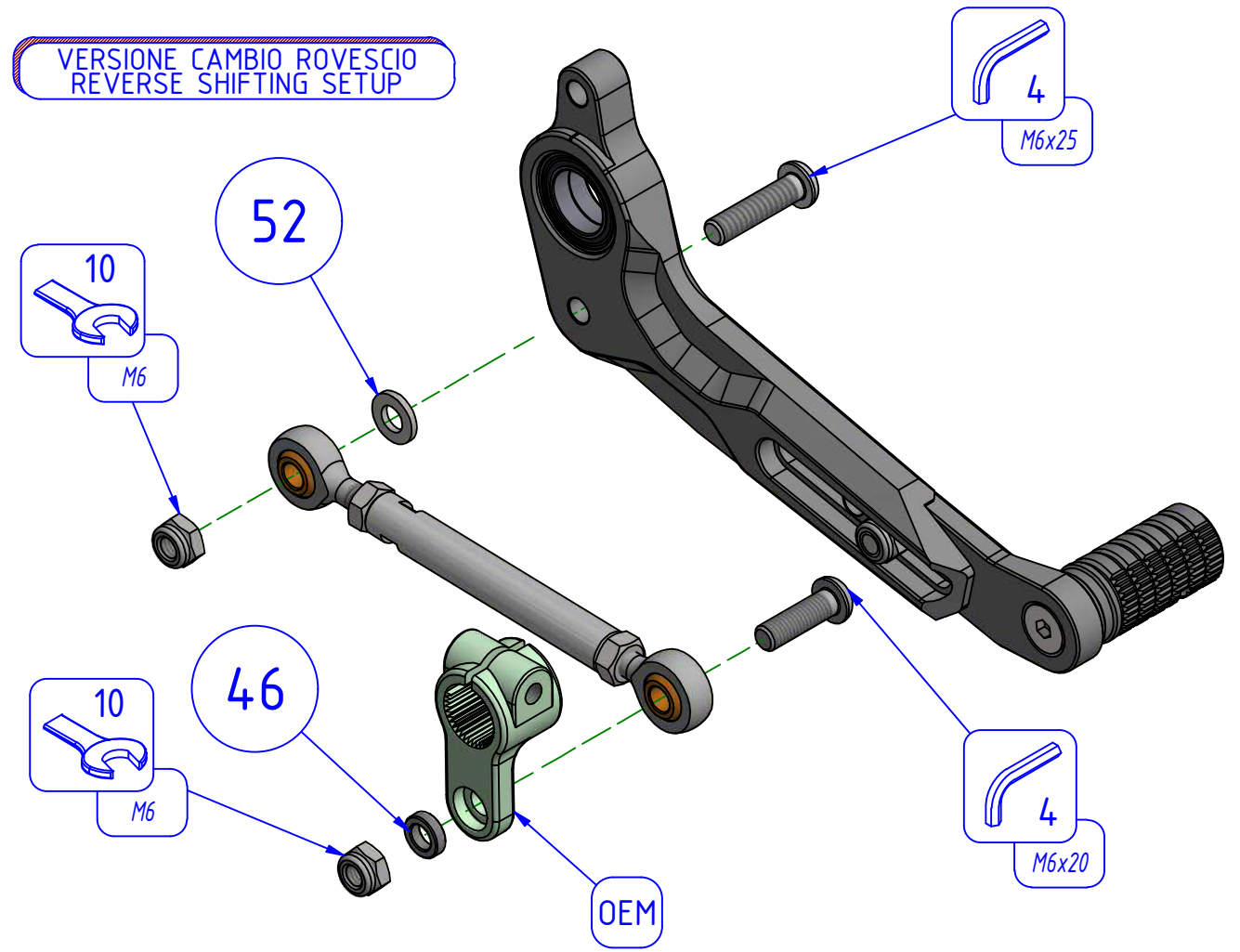

**VERSIONE CAMBIO STRADALE
ROAD SHIFTING SETUP**

